

COMPUTER FREEHOLD REGISTERS

1. SA8D/912

Lot 4 Deposited Plan South Auckland 12082
2.7342 hectares more or less

2. SA57B/357

Lot 2 Deposited Plan South Auckland 71282
3.7670 hectares more or less

3. SA19B/200

Part Tapuaekura Block
31.5843 hectares more or less

4. SA10B/774

Part Lot 2 Deposited Plan 28991
2,575 square metres more or less



**COMPUTER FREEHOLD REGISTER
UNDER LAND TRANSFER ACT 1952**



Historical Search Copy

R. W. Muir
Registrar-General
of Land

Identifier SA8D/912
Land Registration District South Auckland
Date Issued 10 July 1968

Prior References
SA9A/1464

Estate Fee Simple
Area 2.7342 hectares more or less
Legal Description Lot 4 Deposited Plan South Auckland
12082

Original Proprietors
Omni Realty & Services Limited

Interests
B497927.1 Gazette Notice declaring the adjoining State Highway 30 to be a limited access road - 20.8.1998 at
10.01 am
B511976.1 Notice pursuant to Section 91 Transit New Zealand Act 1989 - 12.11.1998 at 12.15 pm

References
Prior C/T. 9A/146L
Transfer No.
N.C. Order No. 8406390



Land and Deeds 69

SA8D/912

REGISTER

CERTIFICATE OF TITLE UNDER LAND TRANSFER ACT

This Certificate dated the 10th day of July one thousand nine hundred and sixty-eight under the seal of the District Land Registrar of the Land Registration District of SOUTH AUCKLAND

WITNESSETH that THE PROPRIETORS OF WAIONE 3B Block are

Image Quality due to Condition of Original

Holder of an estate in fee-simple (subject to such reservations, restrictions, encumbrances, liens, and interests as are notified by memorial indorsement or endorsed hereon) in the land hereinafter described, delineated with bold black lines on the plan hereon, (be the several admeasurements a little more or less, that is to say: All that parcel of land containing 6 ACRES 3 RODS 01.0 PERCH more or less being Lot 4 on Deposited Plan S12082 being part Waione 3B Block



Assistant Land Registrar

S.443948 Transfer to Noel Cole of Auckland Builder produced 3.4.1969 at 11.30 o'clock. Entered 8.10.1969 at 9.00 o'clock
A.L.R.

S.459862 Certificate evidencing that the name of the above incorporation has been changed to The Proprietors of Waione No. 3B No. 8 Block and that all Maori freehold land therein has ceased to be Maori Land and is now held by the said incorporation under provisions of Section 68 Maori Affairs Amendment Act 1967 entered 8.10.1969 at 9.00 o'clock
A.L.R.

H.119029 Transmission to Louis Grogan Wotherspoon company manager and Stanley William Wilford Tong solicitor both of Auckland as executors entered 21.2.1977 at 9.13 o'clock
A.L.R.

H.201119 Transfer to Ian Kinnaird Campbell of Waihao Downs South Canterbury farmer produced 6.10.1978 at 11.03 o'clock
A.L.R.

H.563591.1 Transfer to Moose Holdings Limited at Auckland produced 17.12.1984 at 9.08 o'clock
A.L.R.

H.563591.2 Mortgage to United Building Society produced 17.12.1984 at 9.08 o'clock
A.L.R.

H.563591.3 Mortgage to Ian Kinnaird Campbell produced 17.12.1984 at 9.08 o'clock
A.L.R.

H.563591.4 Mortgage to Bank of New Zealand produced 17.12.1984 at 9.08 o'clock
A.L.R.

XII Rototi S.D.

METRIC AREA IS 2.7341 ha

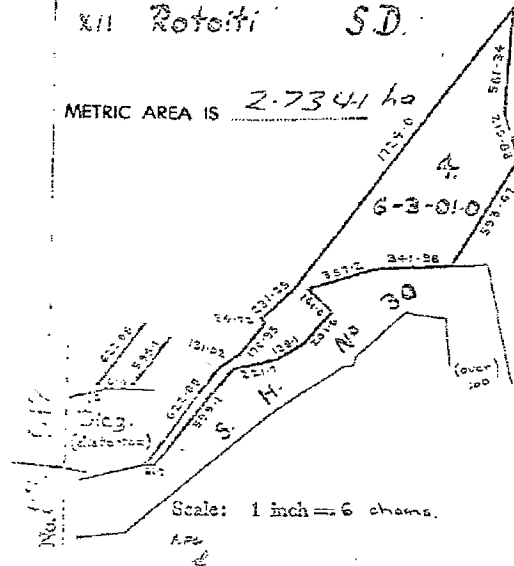

O V E R . . .

CERTIFICATE OF TITLE 8D/912

H.626110.2 Mortgage to Mercantile Securities (Hong Kong) Limited produced 14.11.1985 at 11.56 o/c

H.702282.3

DISCHARGED
13/11/98
for A.L.R.

H.626110.3 Variation of terms of Mortgage H.563591.3 produced 14.11.1985 at 11.56 o/c

H.626110.4 Memorandum of Priority making Mortgage H.626110.2 a first mortgage, Mortgage H.563591.3 a second mortgage and Mortgage H.563591.4 a third mortgage produced 14.11.1985 at 11.56 o/c

H.702282.4 Mortgage to Security Pacific New Zealand Limited produced 12.1.1987 at 2.40 o/c

H.900698.2

DISCHARGED
13/11/98
for A.L.R.

H.739820 Variation of terms of Mortgage H.702282.4 produced 22.7.1987 at 12.30 o/c

H.900698.1 Change of name of mortgagee in Mortgage H.702282.4 to SBSA (NZ) Limited - 13.9.1989 at 1.40 o/c

H.900698.3 Mortgage to SBSA (NZ) Limited - 13.9.1989 at 1.40 o/c

B.185352

DISCHARGED
13/11/98
for A.L.R.

Transfer of Mortgage H.900698.3 to State Bank of South Australia - 7.2.1994 at 9.09 o/c

B.194046.2 Mortgage to State Bank of South Australia - 25.01.1994 at 10.40 o/c

B.237003.2

DISCHARGED
01/11/94
for A.L.R.

B.237003.1 Change of name of mortgagee in Mortgage B.194046.2 to South Australian Asset Management Corporation - 1.11.1994 at 9.00 o/c

B.237003.4 Transfer to Omni Realty & Services Limited - 1.11.1994 at 9.00 o/c

B.497920.1 Gazette Notice declaring State Highway No 30 fronting the within land to be a Limited Access Road - 20.8.1998 at 10.01

B. 54976.1 Certificate pursuant to Section 91 Transit New Zealand Act 1989 authorising a crossing place to and from a Limited Access Road entered 12.11.1998 at 12.15

Teedy

for A.L.R.





**COMPUTER FREEHOLD REGISTER
UNDER LAND TRANSFER ACT 1952**



Historical Search Copy

R. W. Muir
Registrar-General
of Land

Identifier SA57B/357
Land Registration District South Auckland
Date Issued 19 December 1995

Prior References
SA14D/419

Estate Fee Simple
Area 3.7670 hectares more or less
Legal Description Lot 2 Deposited Plan South Auckland
71282

Original Proprietors
Omni Realty & Services Limited

Interests

B497927.1 Gazette Notice declaring the State Highway No. 30 fronting the within land to be a limited access road
- 20.8.1998 at 10.01 am
B511976.1 Notice pursuant to Section 91 Transit New Zealand Act 1989 - 12.11.1998 at 12.15 pm

Identifier

SA57B/357

REGISTER

Land and Deeds 69

No. 57B/357

References

Prior C/T 14D/419
Application B.306193.1
Transfer No.
N/C. Order No. B.306193.3



CERTIFICATE OF TITLE UNDER LAND TRANSFER ACT

This Certificate dated the 19th day of December one thousand nine hundred and ninety five under the seal of the District Land Registrar of the Land Registration District of SOUTH AUCKLAND

WITNESSETH that OMNI REALTY & SERVICES LIMITED

is seized of an estate in fee-simple (subject to such reservations, restrictions, encumbrances, liens, and interests as are notified by memorial underwritten or endorsed hereon) in the land hereinafter described, delineated with bold black lines on the plan hereon, be the several admeasurements a little more or less, that is to say: All that parcel of land containing 3.7670 HECTARES more or less situated in Blocks XI and XII Rotoiti Survey District being Lot 2 on Deposited Plan S.71282

ASSISTANT LAND REGISTRAR

B.497927.1 Gazette Notice declaring State Highway No 30 fronting the within land to be a Limited Access Road - 20.8.1998 at 10.01

 B.L.R.

B.511976.1 Certificate pursuant to Section 91 Transit New Zealand Act 1989 authorising a crossing place to and from a Limited Access Road entered 12.11.1998 at 12.15

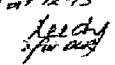
 A.C.D.

No. 57B/357

Measurements are Metric



**COMPUTER FREEHOLD REGISTER
UNDER LAND TRANSFER ACT 1952**



R. W. Muir
Registrar-General
of Land

Historical Search Copy

Identifier SA19B/200
Land Registration District South Auckland
Date Issued 04 July 1975

Prior References
SA14B/420

Estate Fee Simple
Area 31.5843 hectares more or less
Legal Description Part Tapuaekura Block

Original Proprietors
Omni Realty and Services Limited

Interests
9647 Proclamation defining the middle line of road - 13.6.1939 at 9.30 am
B169067.2 Land Improvement Agreement pursuant to the Soil Conservation and Rivers Control Act 1941 -
2.11.1993 at 1.35 pm
B497927.1 Gazette Notice declaring State Highway No 30 fronting the within land to be a Limited Access Road -
20.8.1998 at 10.01 am

References
Prior CJT 140/420

Transfer No.
N/C. Order No. H.042877.1

Land and Deeds 69



REGISTER

No. 19B / 200

CERTIFICATE OF TITLE UNDER LAND TRANSFER ACT

This Certificate dated the 4th day of July one thousand nine hundred and seventy-five under the seal of the District Land Registrar of the Land Registration District of SOUTH AUCKLAND

WITNESSETH that JOHN CHARLES WATT of Rotoiti farmer

is seized of an estate in fee-simple (subject to such reservations, restrictions, encumbrances, liens, and interests as are notified by memorial underwritten or endorsed hereon) in the land hereinafter described, delineated with bold black lines on the plan hereon, be the general admeasurements a little more or less, that is to say: All that parcel of land containing 31.5843 HECTARE more or less being part Tapuaeakura Block



McLennan
ASSISTANT LAND REGISTRAR

9647 Proclamation defining the middle line of road entered 13.6.1939 at 9.30 o'clock

H.246664 Transmission to The New Zealand Insurance Company Limited at Auckland entered 14.8.1979 at 11.12 o'clock

S.51010 Mortgage to the Bank of New South Wales produced 25.6.1957 at 11.00 o'clock
W.246520.1

McLennan
A.L.R.
R. Forster
A.L.R.
McLennan
A.L.R.

R. Forster
for A.L.R.

H.249667.1 Transfer to Gerd Block of Wellington architect and Renate Christa Block his wife produced 30.8.1979 at 1.55 o'clock

Blks XI and XII Rotoiti S.D.

H.249667.2 Mortgage to The New Zealand Insurance Company Limited produced 30.8.1979 at 14.55 o'clock
H.515093.1

McLennan
for A.L.R.
McLennan
for A.L.R.

H.515093.2 Transfer to Gerd Block and Renate Christa Block both abovenamed as tenants in common in equal shares produced 14.3.1984 at 9.10 o'clock

McLennan
for A.L.R.

H.554075 Transmission to the Public Trustee entered 29.10.1984 at 9.15 o'clock

ENTERED IN ERROR
H.554075 Transmission of one half share of Renate Christa Block to the Public Trustee entered 29.10.1984 at 9.15 o'clock

Amended O. Forster

McLennan
for A.L.R.

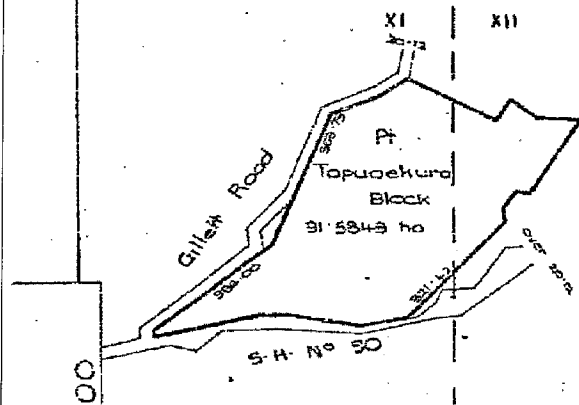

No. 19B / 200

Measurements are Metric
M.L. 3220
S.O.38336

OVER . . .

Register copy for L. & D. 69, 71, 72

CERTIFICATE OF TITLE 19B/200

H.597155.1 Transfer to Murray McKenzie Toms of Rotorua company director produced 26.6.1985 at 9.32 o'clock

H.597155.2 Mortgage to The Public Trustee produced 26.6.1985 at 9.32 o'clock
14902934
CHARGED
For A.L.R.

B.155681 CAVEAT BY ROBIN JOHN FINLAY AND DELYS MARJORIE FINLAY 16.8.1993 AT 11.20 o'clock
B.155681
For A.L.R.

B.169067.2 Land Improvement Agreement under the Soil Conservation and Rivers Control Act 1941 - 2.11.1993 at 1.35 o'clock
For A.L.R.

B.169067.3 Transfer to Robin John Finlay farmer and Delys Marjorie Finlay school teacher both of Palmerston North - 2.11.1993 at 1.35 o'clock
C. Heath
For A.L.R.

B.172289 Mortgage to ANZ Banking Group (New Zealand) Limited 15.11.1993 at 12.21 o'clock
B.172289
CHARGED
For A.L.R.

B.244510.2 Transfer to Omni Realty and Services Limited - 8.12.1994 at 9.02 o'clock
B.244510
CHARGED
For A.L.R.

B.47937.1 Gazette Notice declaring State Highway No. 30 fronting the within land to be a Limited Access Road - 20.8.1993 at 10.00 o'clock
B.47937
For A.L.R.

B.511976.1 Certificate pursuant to Section 91 Transit New Zealand Act 1989 authorising a crossing place to and from a Limited Access Road entered 12.11.1998 at 12.15 o'clock
B.511976
For A.L.R.





**COMPUTER FREEHOLD REGISTER
UNDER LAND TRANSFER ACT 1952**



Historical Search Copy

R. W. Muir
Registrar-General
of Land

Identifier SA10B/774
Land Registration District South Auckland
Date Issued 03 April 1969

Prior References
SA9A/1464

Estate Fee Simple
Area 2575 square metres more or less
Legal Description Part Lot 2 Deposited Plan 28991

Original Proprietors
Omni Realty & Services Limited

Interests

B497927.1 Gazette Notice declaring State Highway No 30 fronting the within land to be a limited access road - 20.8.1998 at 10.01 am
B511976.1 Notice pursuant to Section 91 Transit New Zealand Act 1989 authoring a crossing place to and from a Limited Access Road - 12.11.1998 at 12.15 pm

References
Prior C/T. 9A/1464

Transfer No. S.443948
N/C. Order No.



S

Land and Deeds 69

REGISTER

No. 103/774

CERTIFICATE OF TITLE UNDER LAND TRANSFER ACT

This Certificate dated the 3rd day of April one thousand nine hundred and sixty-nine under the seal of the District Land Registrar of the Land Registration District of South Auckland

WITNESSETH that NOEL COLE of Auckland builder

is seized of an estate in fee-simple (subject to such reservations, restrictions, encumbrances, liens, and interests as are notified by memorial underwritten or endorsed hereon) in the land hereinafter described, delineated with bold black lines on the plan hereon, be the several admeasurements a little more or less, that is to say: All that parcel of land containing 2 ROODS 21.8 PERCHES more or less being part Lot 2 on Deposited Plan 28991 and being part Waiong 3B8 Block



Subject to Proclamation 964 defining the middle line of a road *See #93732*

H.201119 Transfer to Ian Kinnaird Campbell of Waikato South Canterbury farmer produced 6.10.1976 at 11.03 o/c

H.119029 Transmission to Louis Grogan Wotherspoon company manager and Stanley William Wilford Tong solicitor both of Auckland as executors entered 21.2.1977 at 9.13 o/c

H.563591.1 Transfer to Moose Holdings Limited at Auckland produced 17.12.1984 at 9.08 o/c

XI & XII Rotoiti S.D.

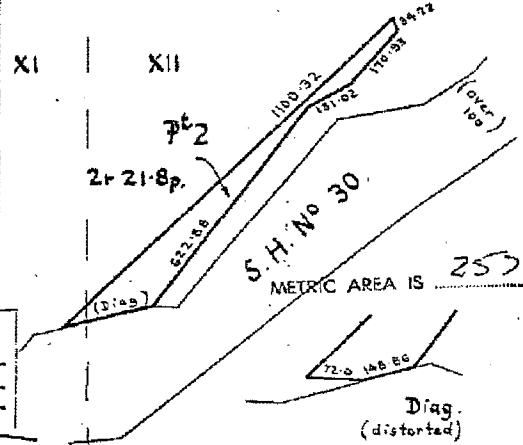

H.563591.2 Mortgage to United Building Society produced 17.12.1984 at 9.08 o/c

H.563591.3 Mortgage to Ian Kinnaird Campbell produced 17.12.1984 at 9.08 o/c

H.563591.4 Mortgage to Bank of New Zealand produced 17.12.1984 at 9.08 o/c

H.626110.2 Mortgage to Merchants Securities (Hong Kong) Limited produced 14.11.1985 at 11.45 o/c

H.626110.3 Variation of terms of Mortgage H.563591.3 produced 14.11.1985 at 11.56 o/c

H.626110.4 Memorandum of Priority making Mortgage H.626110.2 a first mortgage, Mortgage H.563591.3 a second mortgage and Mortgage H.563591.4 a third mortgage produced 14.11.1985 at 11.59 o/c

Scale: 1 inch = 3 chains. S.O. 38336

No. 103/774

H.702282.4 Mortgage to Security Pacific
New Zealand Limited produced 12.1.1987 at
2.40 o/c

H.900698.2

DISCHARGED
13/9/1989
for A.L.R.

[Signature]
for A.L.R.

H.739820 Variation of terms of Mortgage
H.702282.4 produced 22.7.1987 at 12.30 o/c

[Signature]
for A.L.R.

H.900698.1 Change of name of mortgagee
in Mortgage H.702282.4 to SBSA (NZ) Limited
- 13.9.1989 at 1.40 o/c

[Signature]
for A.L.R.

H.900698.3 Mortgage to SBSA (NZ) Limited
- 13.9.1989

B194046.1

DISCHARGED
21/10/1994
for A.L.R.

[Signature]
for A.L.R.

B.185352 Transfer of Mortgage H.900698.3 to
State Bank of South Australia - 7.2.1994 at
9.09 o/c

[Signature]
for A.L.R.

B.194046.2 Mortgage to State Bank of South
Australia - 25.3.1994 at 10.40 o/c

B237003.2

DISCHARGED
21/10/1994
for A.L.R.

[Signature]
for A.L.R.

B.237003.1 Change of name of mortgagee
in Mortgage B.194046.2 to South
Australian Asset Management Corporation
- 1.11.1994 at 9.00 o/c

[Signature]
for A.L.R.

B.237003.4 Transfer to Omni Realty &
Services Limited - 1.11.1994 at 9.00 o/c

[Signature]
for A.L.R.

B.497927.1 Gazette Notice declaring State
Highway No 20 fronting the within land to
be a Limited Access Road - 20.8.1998 at 10.00

[Signature]
for A.L.R.

B.511976.1 Certificate pursuant to Section
91 Transit New Zealand Act 1989 authorising
a crossing place to and from a Limited
Access Road entered 12.11.1998 at 12.15

[Signature]
for A.L.R.

